



# STAR TREK

**U.S.S. ENTERPRISE™**  
**NCC-1701**  
 PLASTIC ASSEMBLY MODEL KIT

## ASSEMBLY INSTRUCTIONS

1:350 SCALE • SKILL LEVEL 2 AGES 10+

POLAR LIGHTS®

TM, © & © 2012 CBS Studios Inc. STAR TREK and related marks are trademarks of CBS Studios Inc. All rights reserved.

Polar Lights and Round 2 and design are trademarks of Round 2, LLC. ©2012 Round 2, LLC, South Bend, IN 46628 USA. Product and packaging designed in the USA. Made in China. All rights reserved.

*This model kit is the result of years of researching the U.S.S. Enterprise filming miniature used in the production of Star Trek: The Original Series. From its hull color to the last detail (even some imperceptible on-screen) every effort has been made to make the kit accurately represent the ship. The kit has been engineered to build easily and to incorporate optional parts to create either of the pilot versions of the ship with parts included in the **Supplemental Parts Pack** and to accept a specially developed **Deluxe Accessory Set** that contains lights, detailed photo-etch parts and weathering decals to deliver the utmost in the finish of the ship. (See your model retailer or [round2models.com](http://round2models.com) for more info on the **Supplemental Parts Pack** and **Deluxe Accessory Set**. Available now!) Some details and structures found inside the kit parts are present to facilitate these options. If using either of these products, review the instructions contained in them before beginning construction to note the additional steps required for the installation of optional or electronic parts.*

**GENERAL ASSEMBLY:** This highly detailed kit features precision-tooled parts for ease of assembly, but care and patience must be exercised to achieve optimal results. It is recommended that the builder examine the instructions carefully and do a dry test fit of parts before applying cement. You will find this very helpful, as it will allow you to gain a clear understanding of how the parts fit together in order to best plan painting and final assembly. In addition, it is important to note that the majority of clear parts (especially windows) are designed to be cemented in place from the backside of main parts.

Window parts have been included in three options - clear, white and dark tint. The modeler can mix and match as desired. To achieve an accurate on-screen appearance, some window parts may need to be divided further. See box tray side diagrams to see the window arrangement of the filming model.

**SUB-ASSEMBLIES:** Note that this kit is intended to be built in sub-assemblies. This makes building the kit far more manageable. It is very important to note that it is extremely advantageous to apply paint and decals to sub-assemblies before completing final assembly. This is particularly true in the case of interior assemblies, which may require extensive paint work, depending on the level of detail the modeler wishes the finished kit to have. If using optional weathering decals, they should be applied to the surface of the ship before applying included markings and registries.

**INTERIOR ASSEMBLIES:** It is important to note that there are several interior assemblies that must be completed first, including paint and decals, before fitting into exterior hull sections.

**PAINT & DECALS:** The plastic color of the ship provides the best reference for the accurate color of the filming model. Parts are supplied in light gray, medium gray and copper which closely represent the colors of the original model. The sides of the box tray supply further instruction on paint colors and decal placement. The colored numbers on the box diagrams show close approximations of color. Paint formulas shown on the box suggest quick mixes of existing paint colors. Some builders may rely on their own research to explore more accurate color mixes to suit their own interpretation of the color.

To achieve a semblance of the on-screen appearance of the engine Bussard collector domes, they should be dulled down. This can be achieved in a variety of ways, but dull coat sprayed on the outside of the dome is the easiest method.

In some cases, the application of certain decals should occur before completing a sub-assembly. These instances are noted in the assembly diagrams on this sheet.

After all decals are applied, a spray of dull coat is suggested to bury and protect the decals as well as hide surface imperfections and supply a lifelike final appearance to the model.

### KEY TO NUMBERS

- OPAQUE PLASTIC PART **1**  
 CLEAR PLASTIC PART **102**  
 SUB-ASSEMBLY (STEP) **3**  
 FRAME IDENTIFIER **IV**

FIND THE PART YOU NEED BY USING THE IDENTIFIER LOCATED IN THE CORNER OF EACH FRAME.



USE SHARP NIPPERS TO DETACH CERTAIN PARTS AS SHOWN HERE.

Special thanks to E. James Small, Michael W. Anderson (aka Club Tepes) and Gary Kerr along with his associates Petri Blomqvist, Phil Lundgren and Richard Shafer for all of their contributions in the development of this kit. Decal artwork by Frederick Barr.



# 1 • B/C DECK

Orient the bridge (#7) as desired by using the notches in part #3.

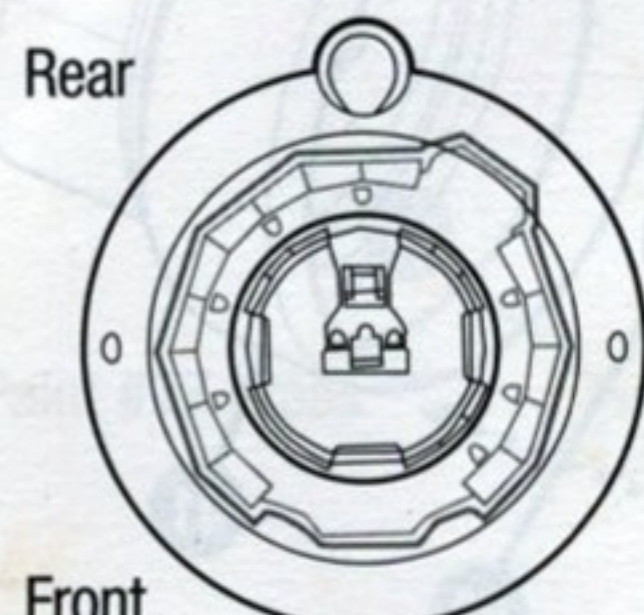

Face com forward  
OR  
match turbo lift  
doors to exterior

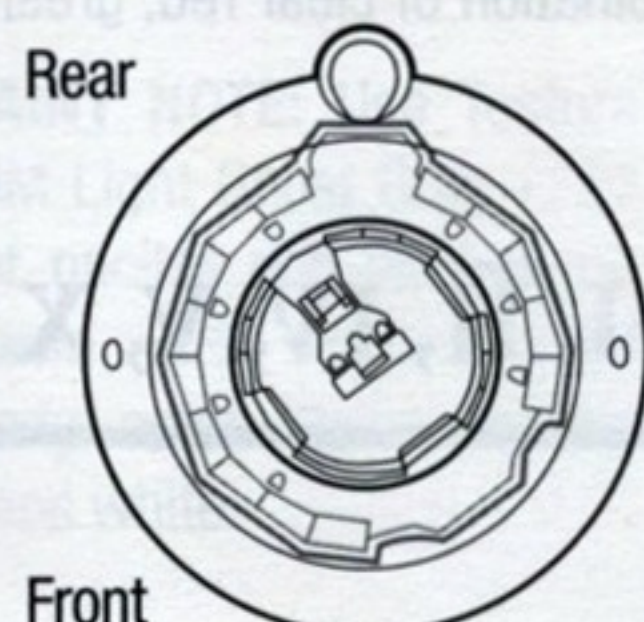

I, IX, X, IV

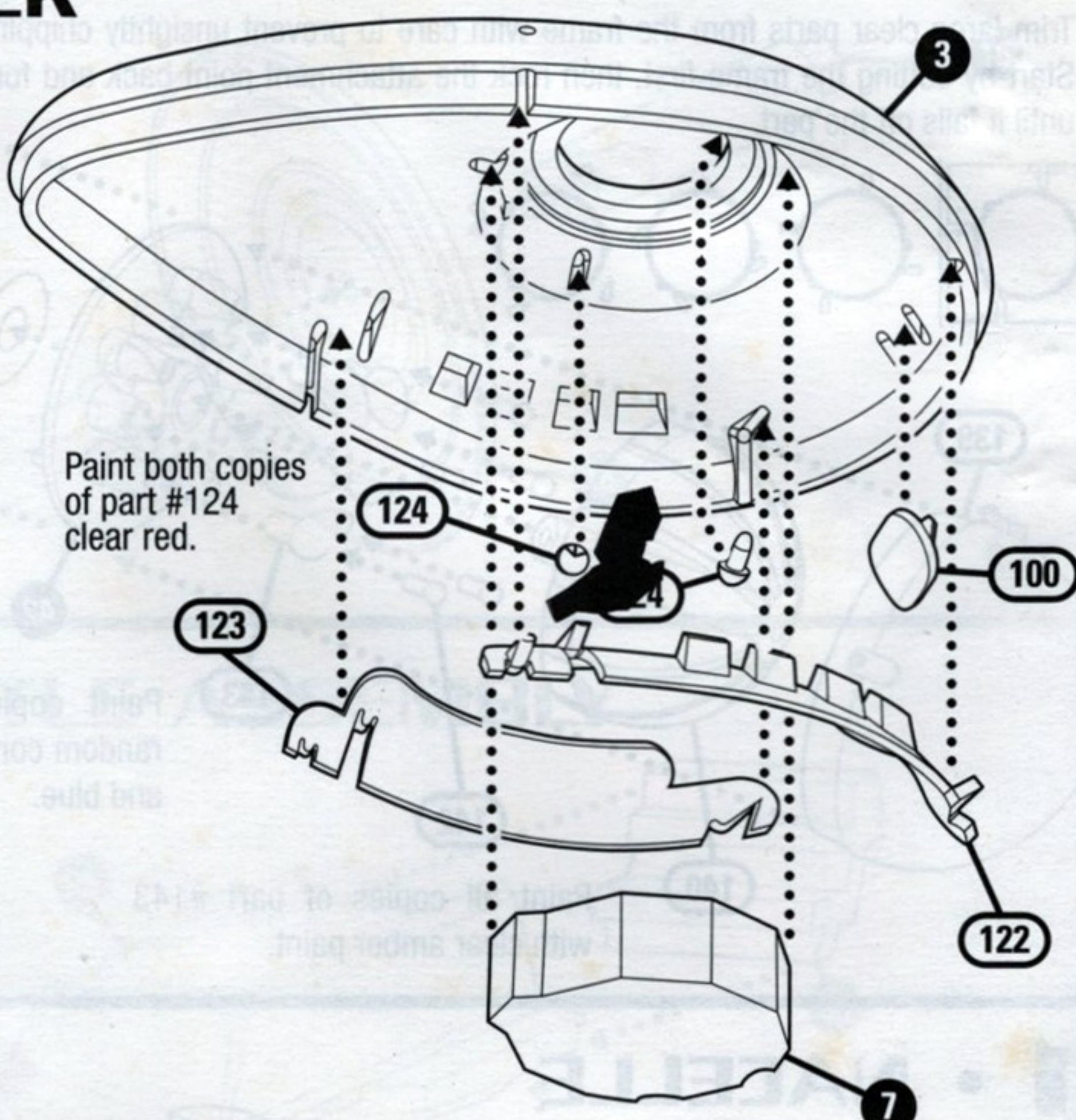

# 2 • UPPER SAUCER

Paint the starboard (right side) parts #105 & 106 clear green. Paint the port (left side) parts #105 & 106 clear red.

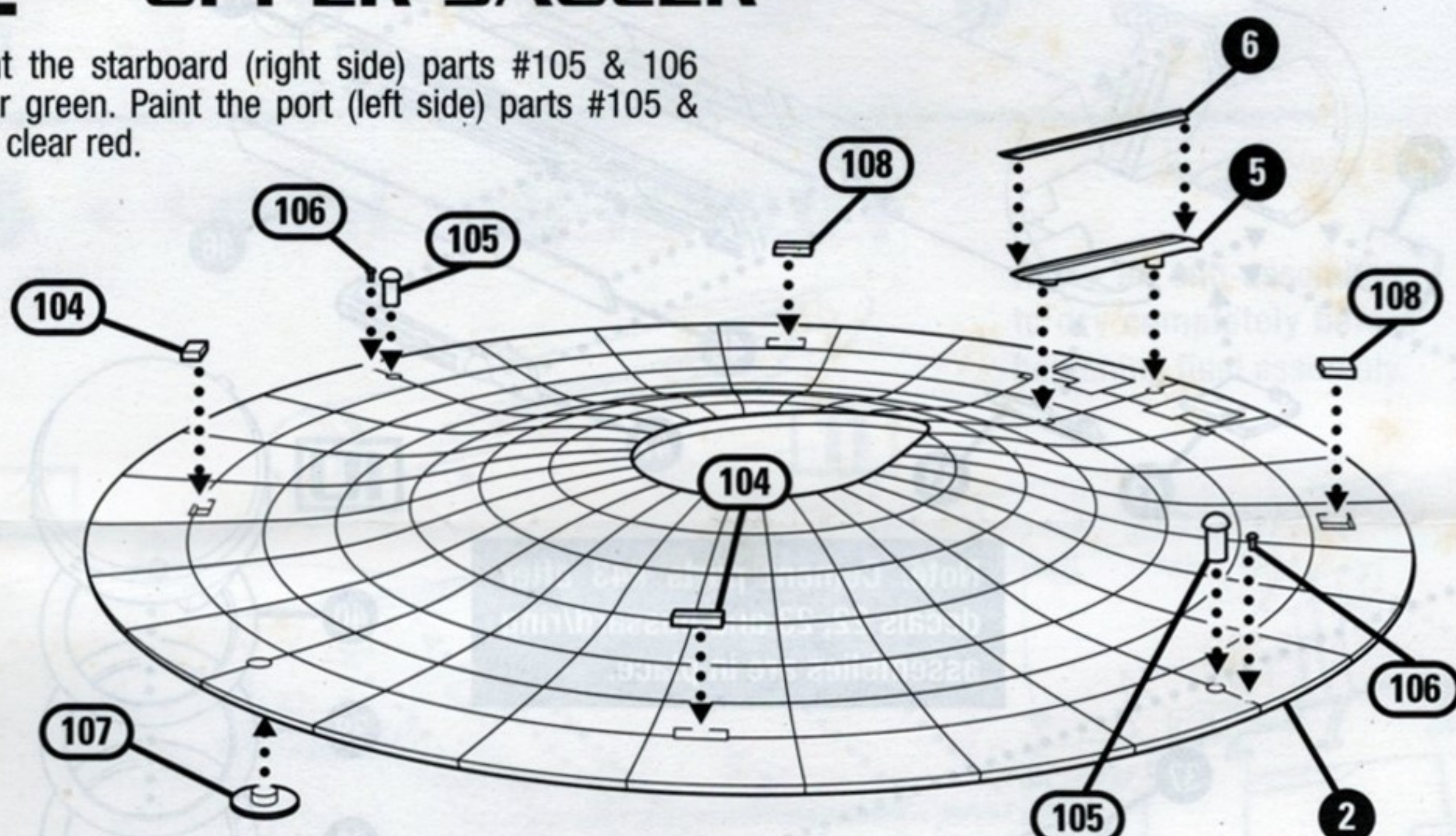

II, VIII, X

# 3 • LOWER SAUCER

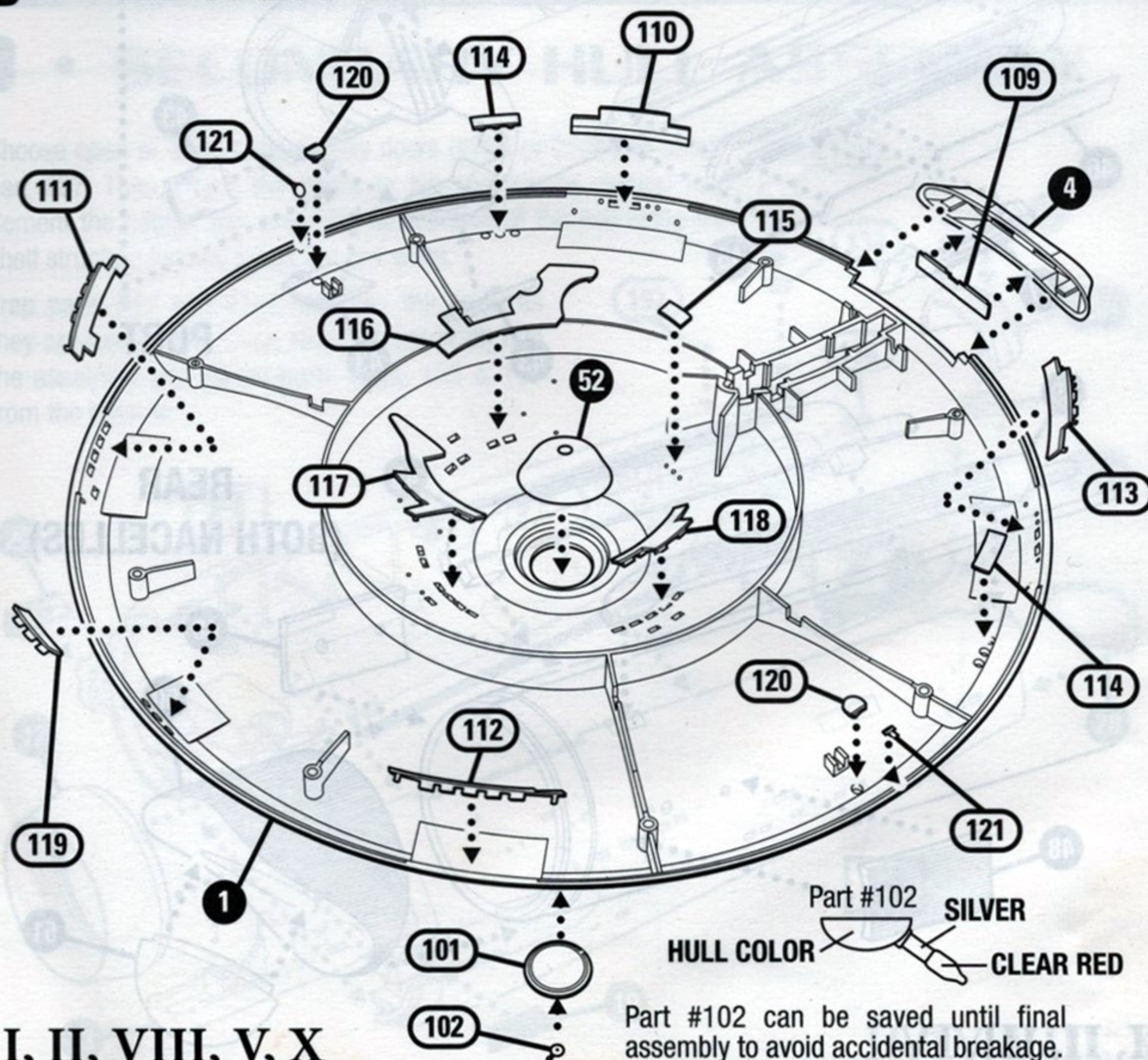

I, II, VIII, V, X



## 4 • SAUCER ASSEMBLY

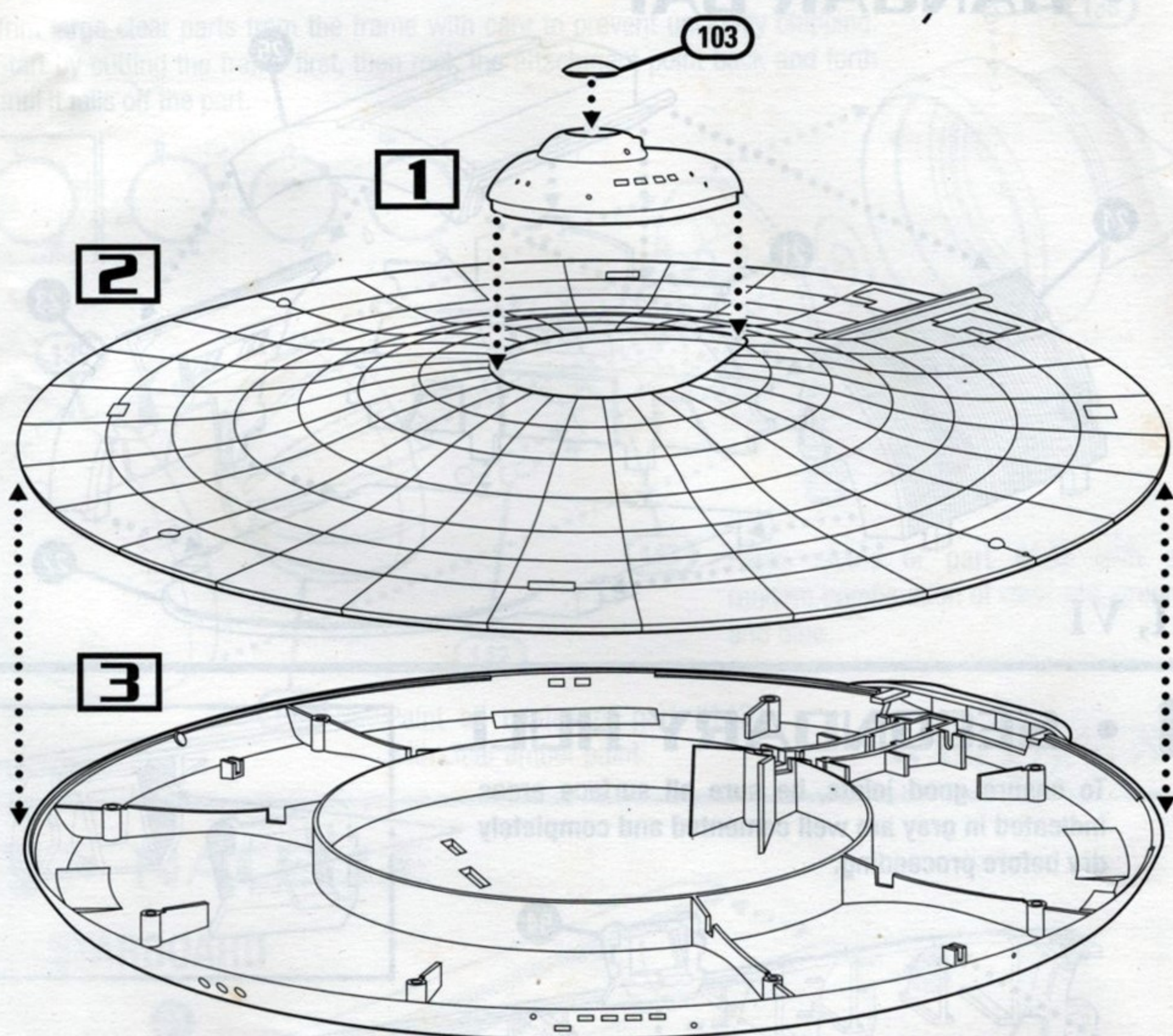

VIII

## 5 • SAUCER PYLON

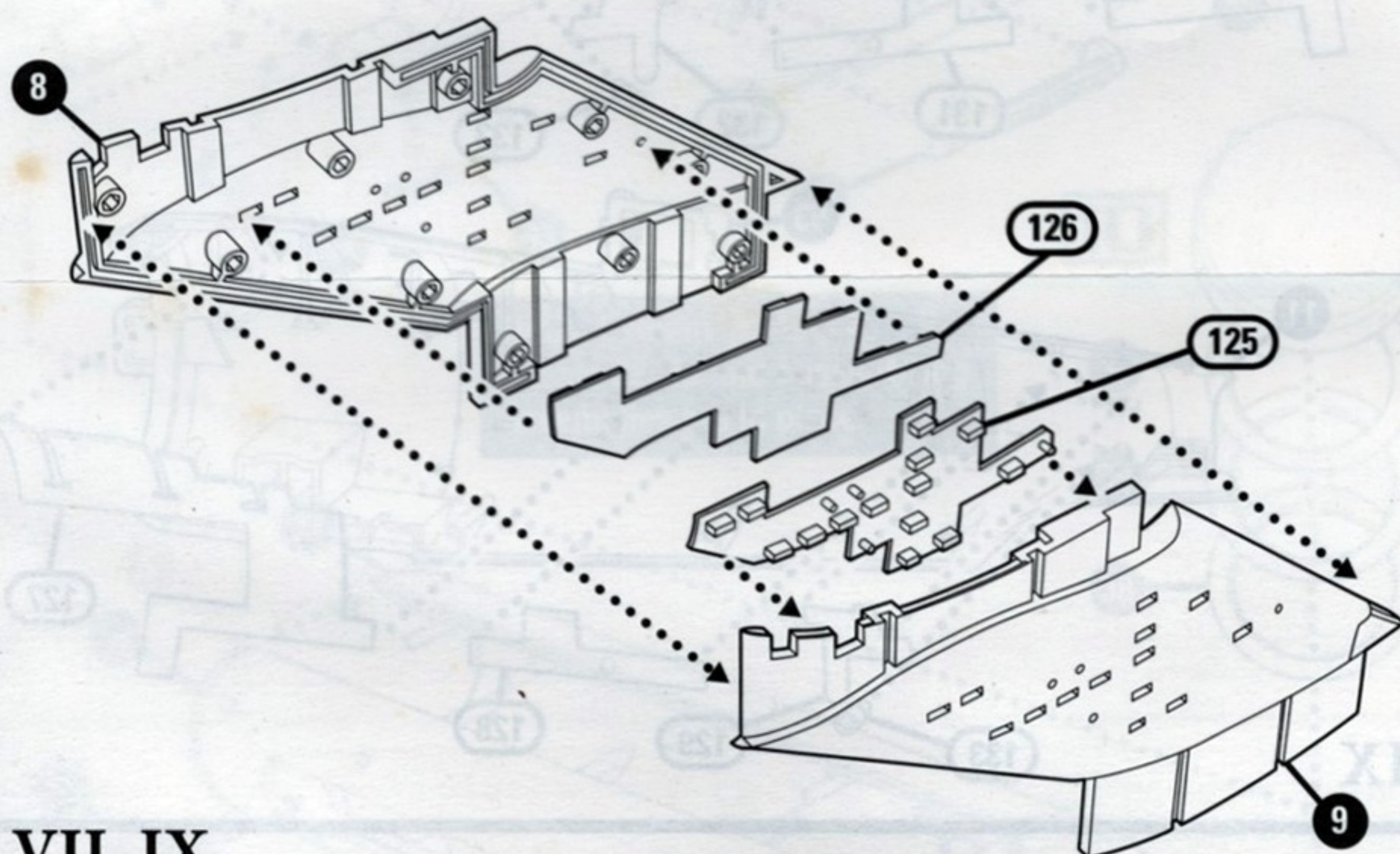

VII, IX

## 6 • NACELLE PYLONS

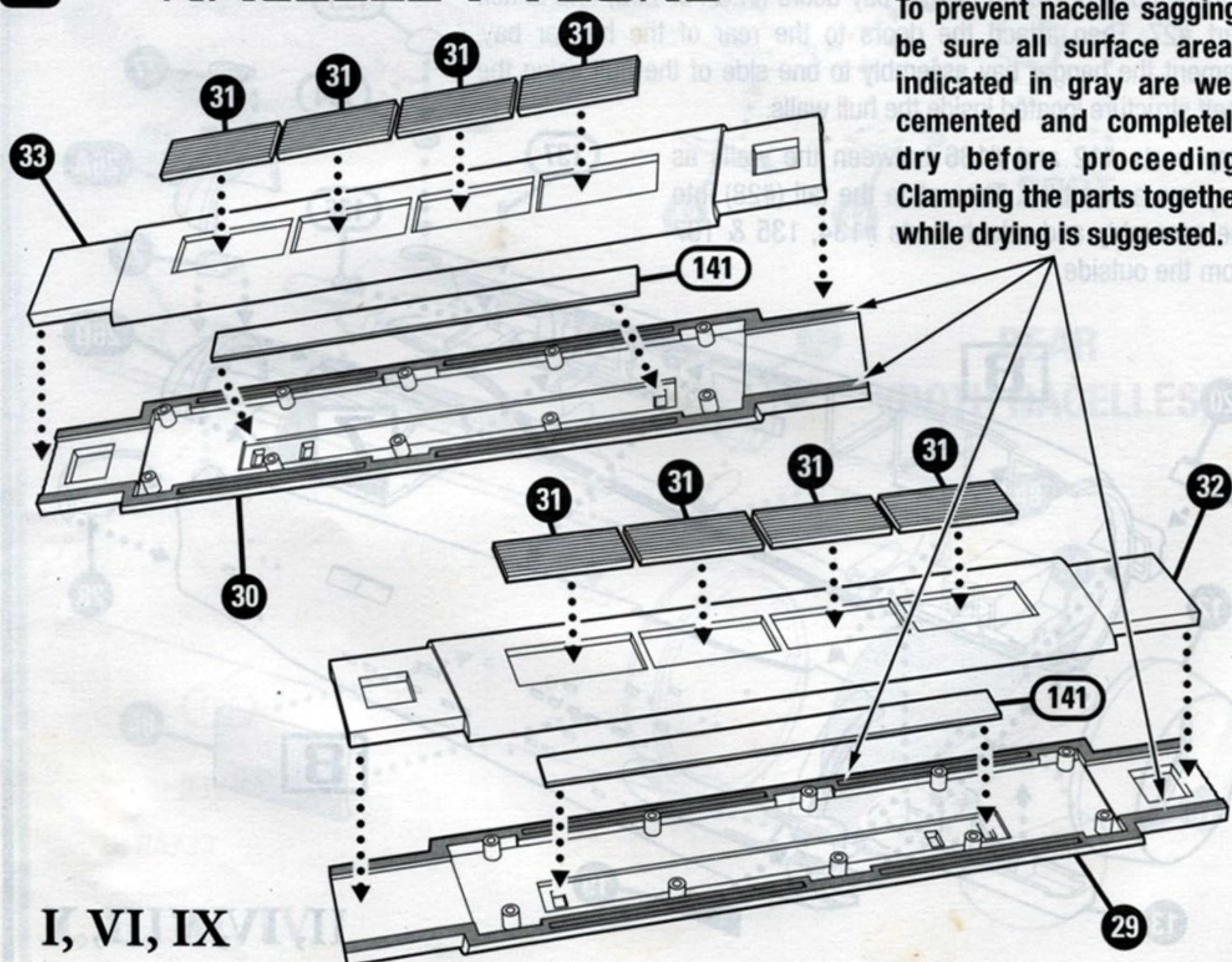

I, VI, IX



## 7 • HANGAR BAY

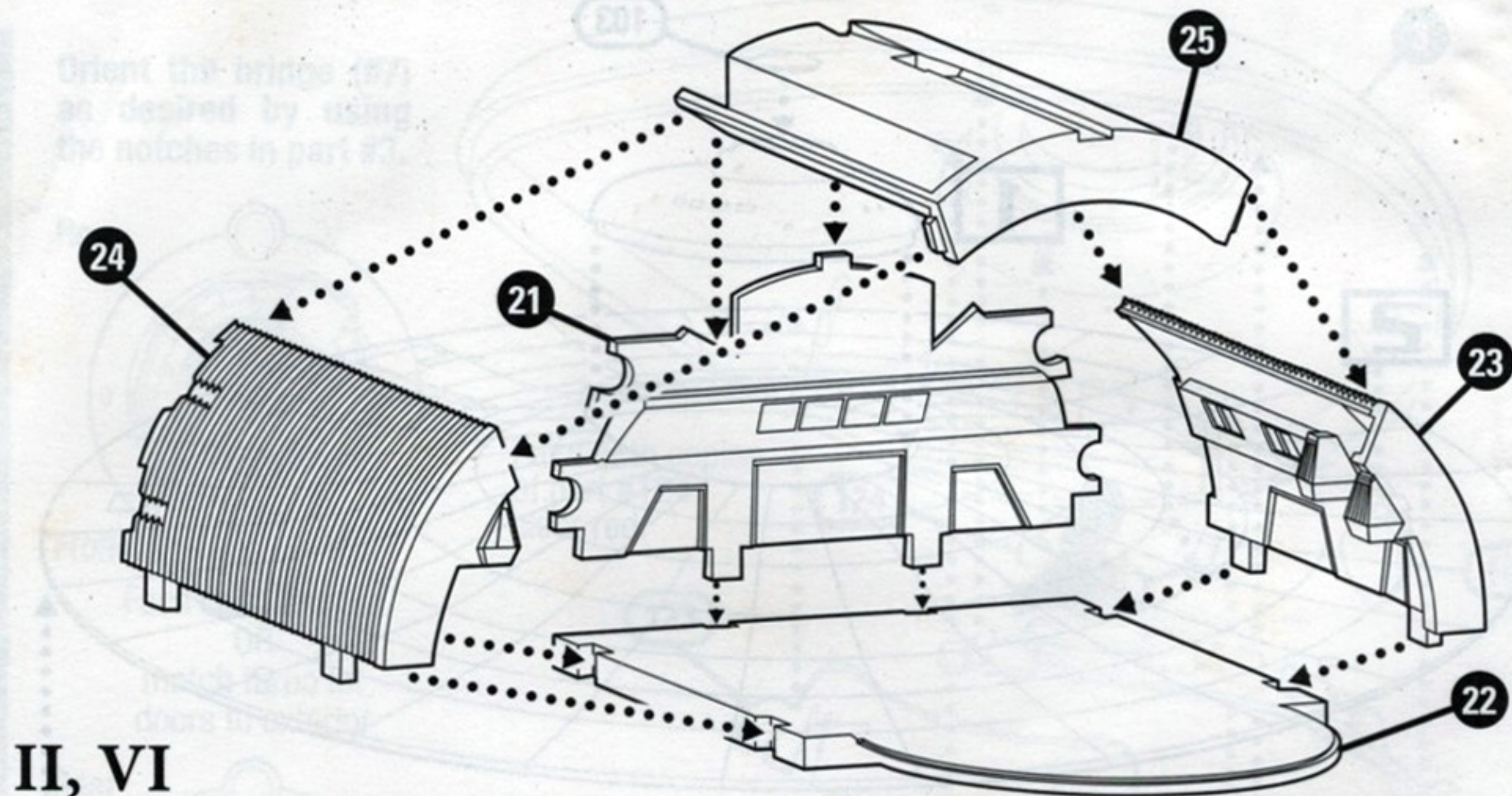

II, VI

## 8 • SECONDARY HULL

To ensure good joints, be sure all surface areas indicated in gray are well cemented and completely dry before proceeding.

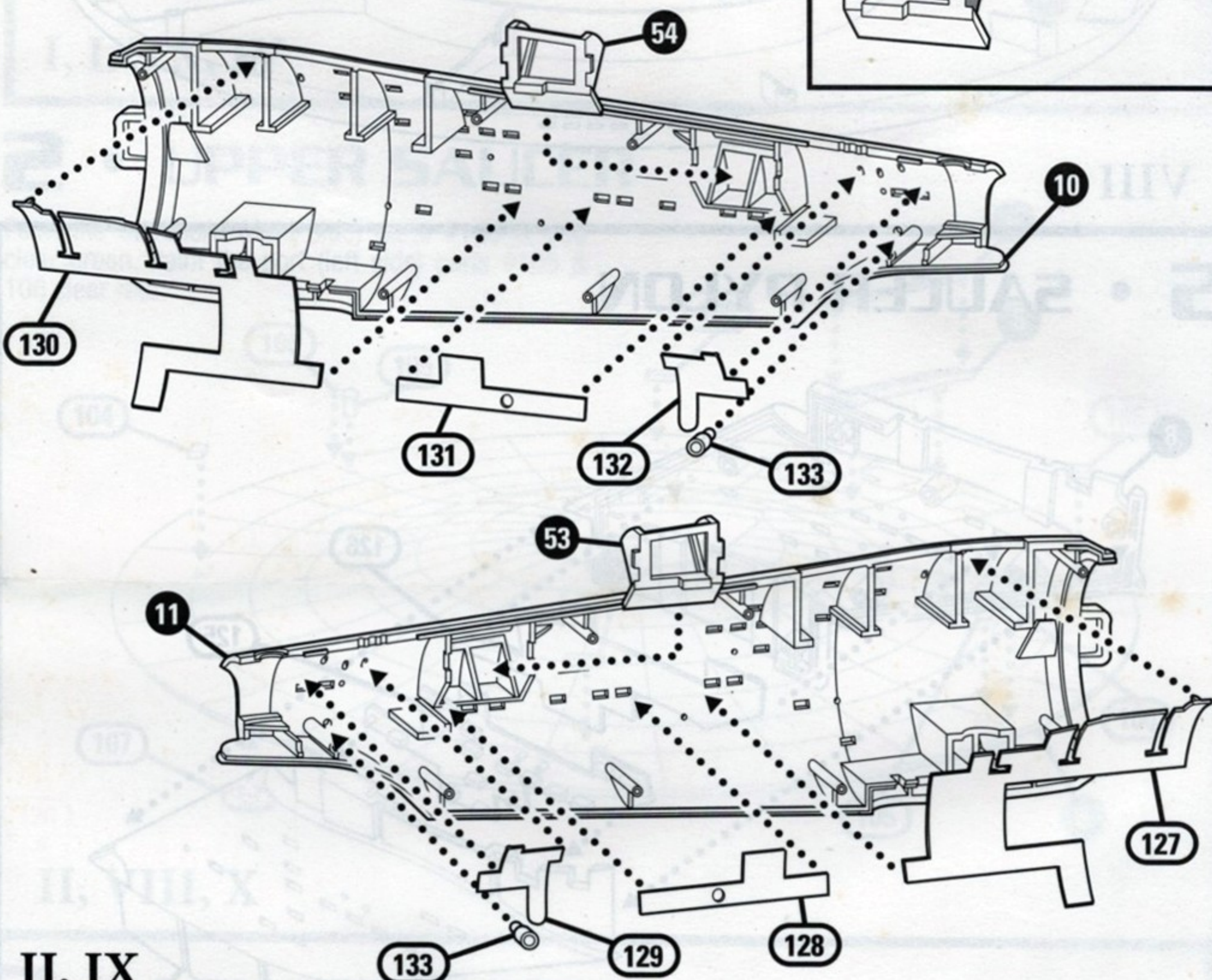

II, IX

## 9 • SECONDARY HULL ASSEMBLY

Choose open or closed hangar bay doors (#26A or 26B) and attach part #27. Then attach the doors to the rear of the hangar bay. Cement the hangar bay assembly to one side of the hull using the shelf structure located inside the hull walls.

Trap parts #12 and #136 between the walls as they are assembled. Then slide the tail (#28) into the assembly and attach parts #134, 135 & 137 from the outside.

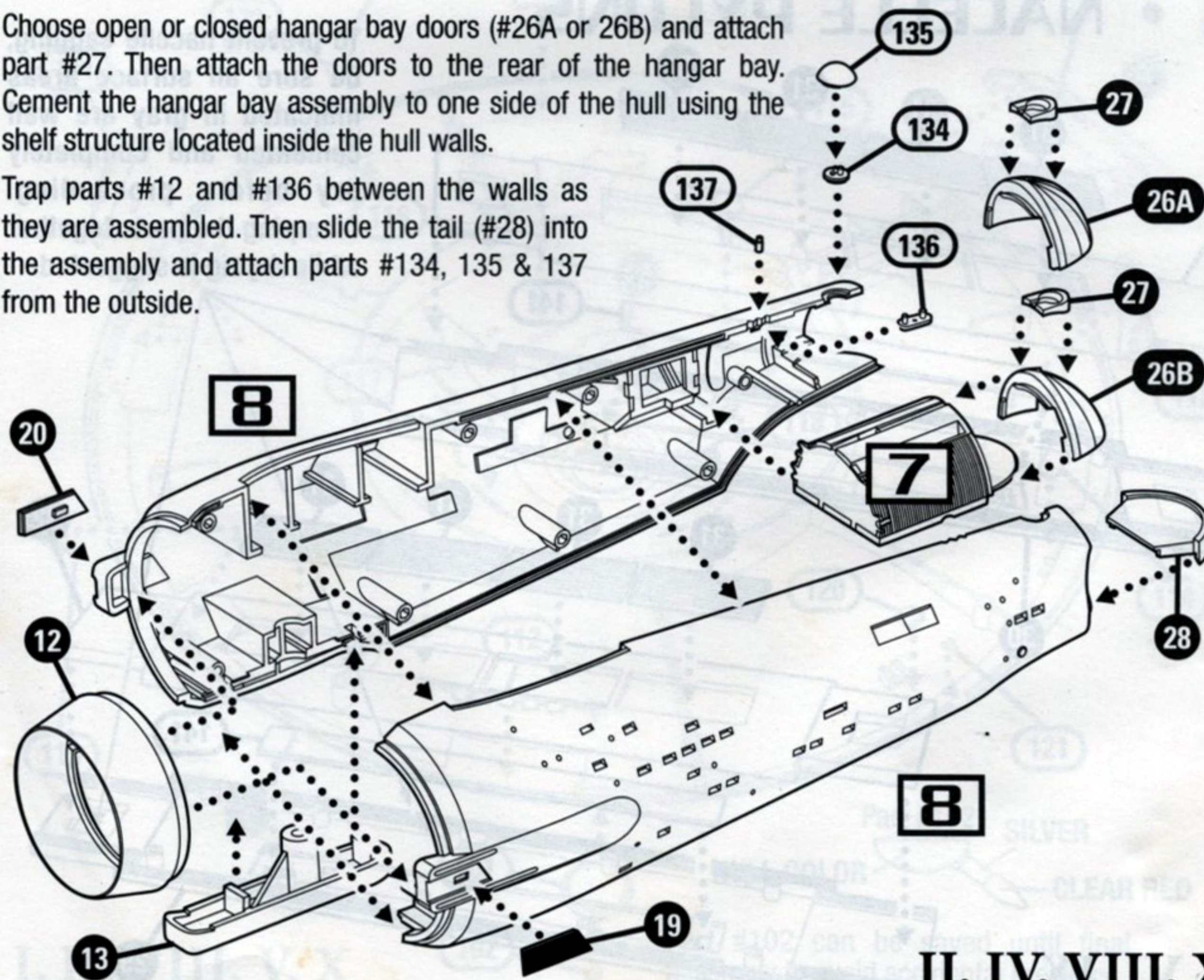

II, IV, VIII, X



# 10 • BUSSARD COLLECTOR

Trim large clear parts from the frame with care to prevent unsightly chipping. Start by cutting the frame first, then rock the attachment point back and forth until it falls off the part.

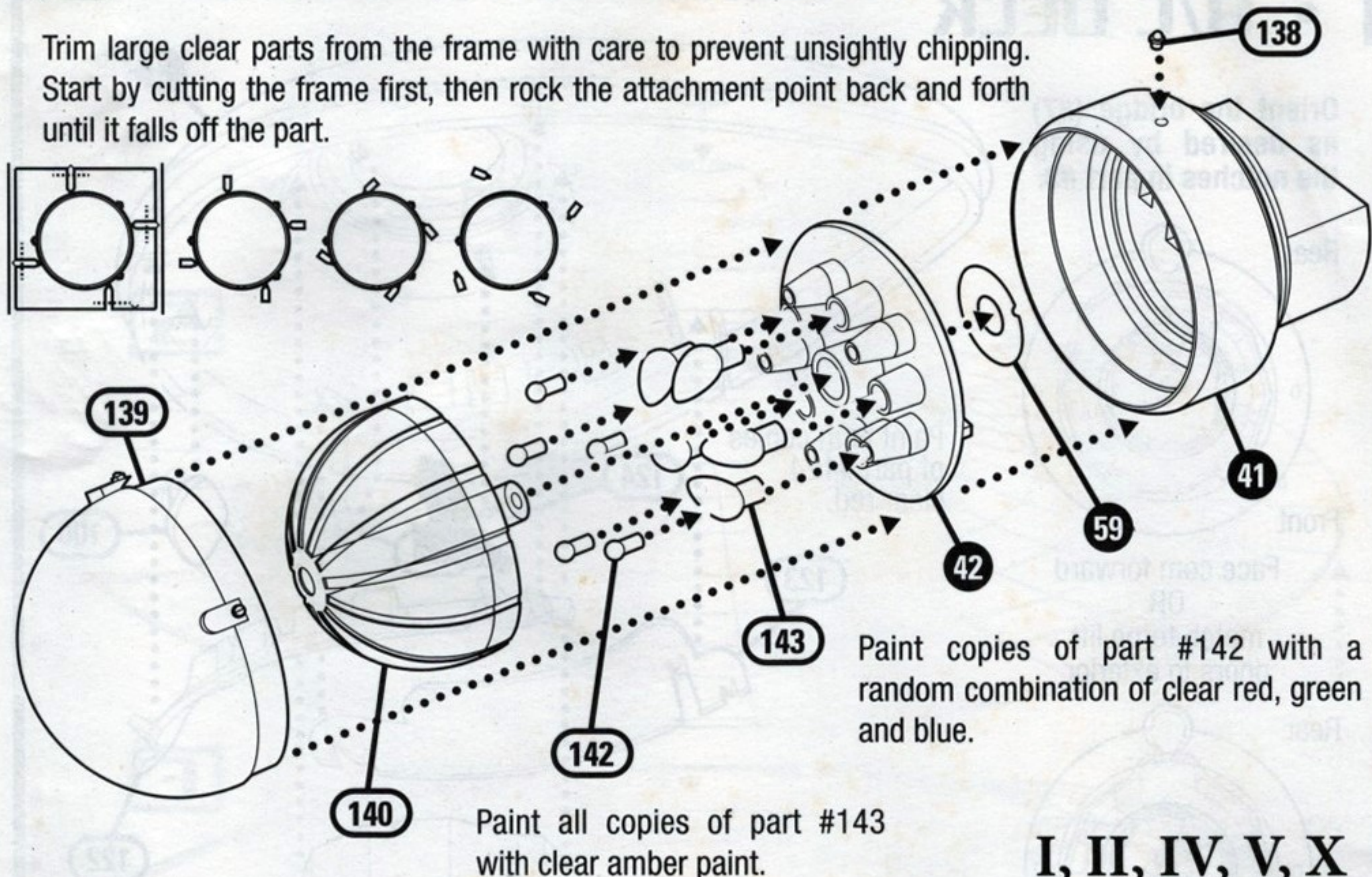

# 11 • NACELLE

STARBOARD

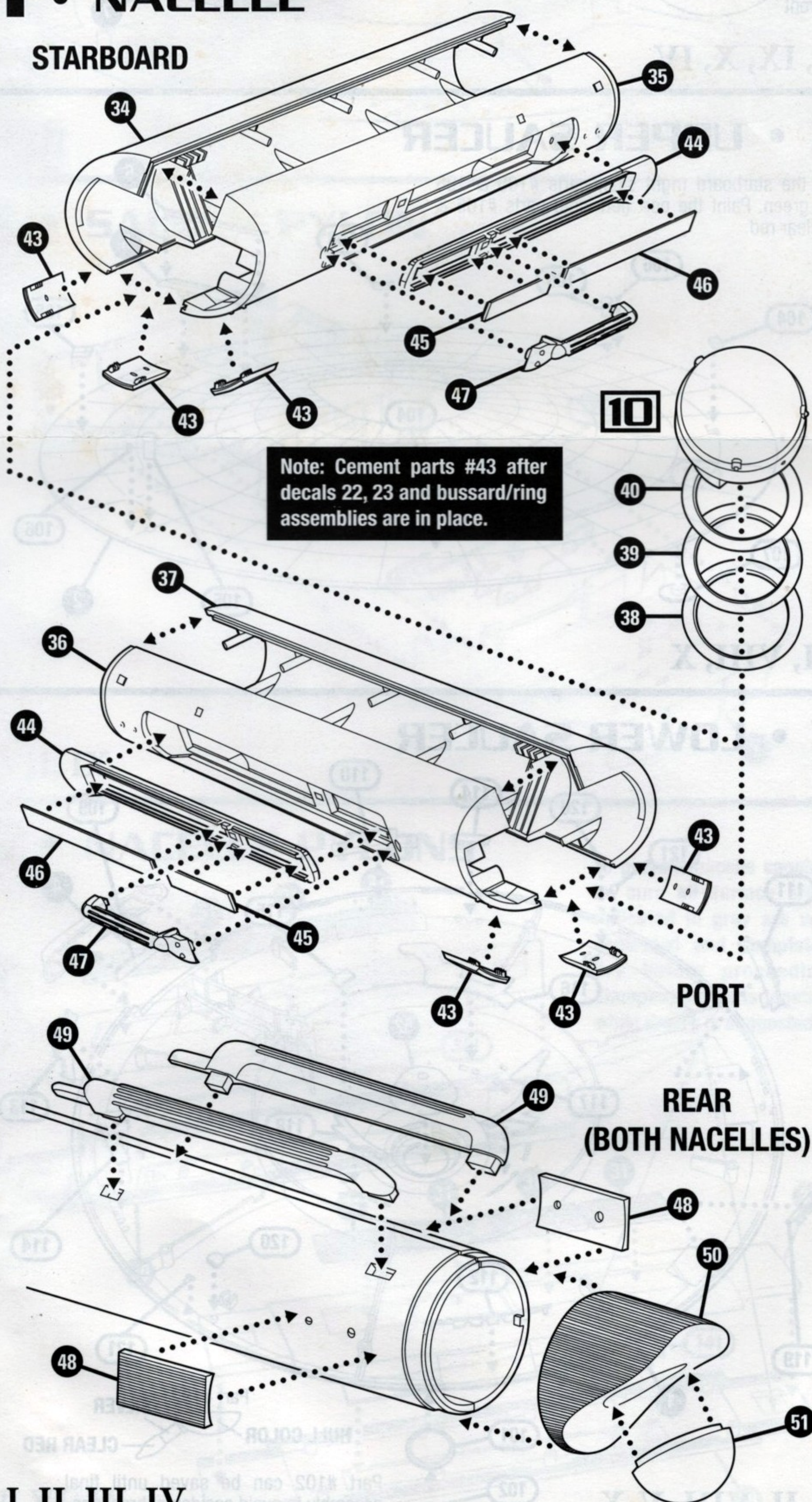



# 12 • DEFLECTOR DISH

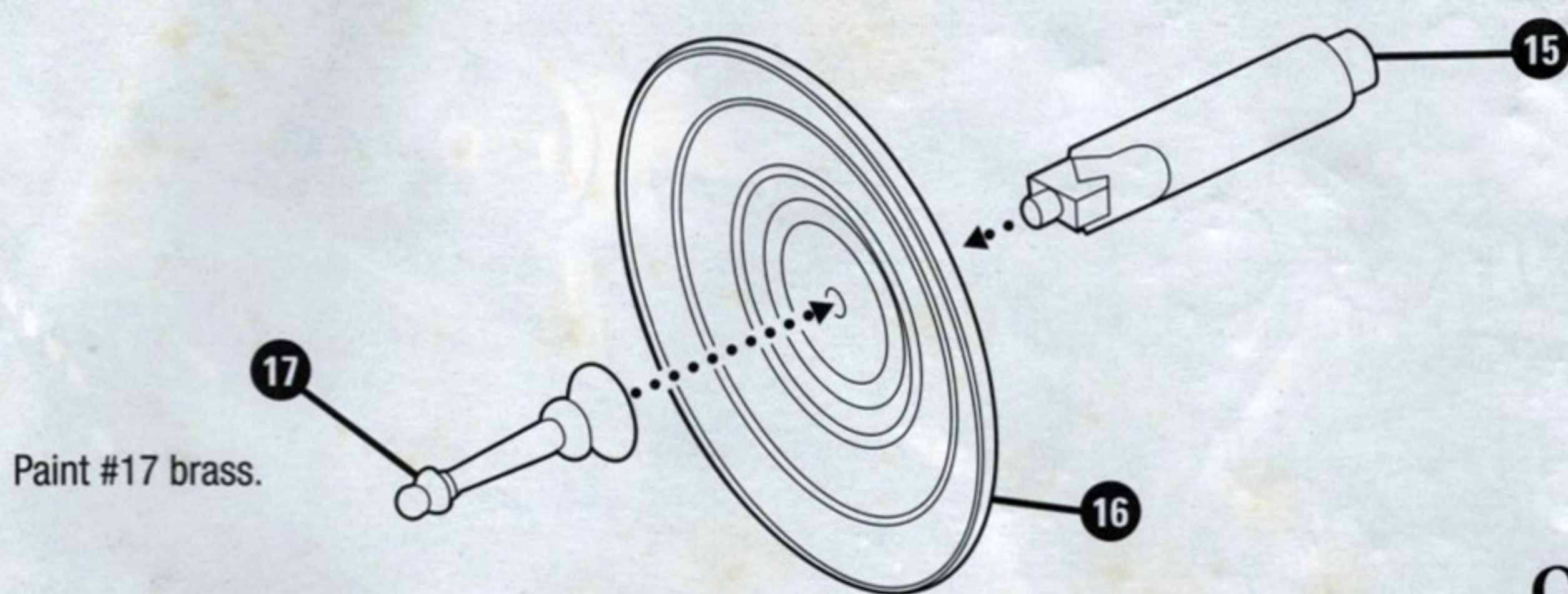

0

# 13 • SHUTTLE ASSEMBLY

**PAINT NOTE:** Use Testors MM Light Ghost Gray 1728 for nacelles and lighten the same color for the main body color. Paint nacelle caps white.

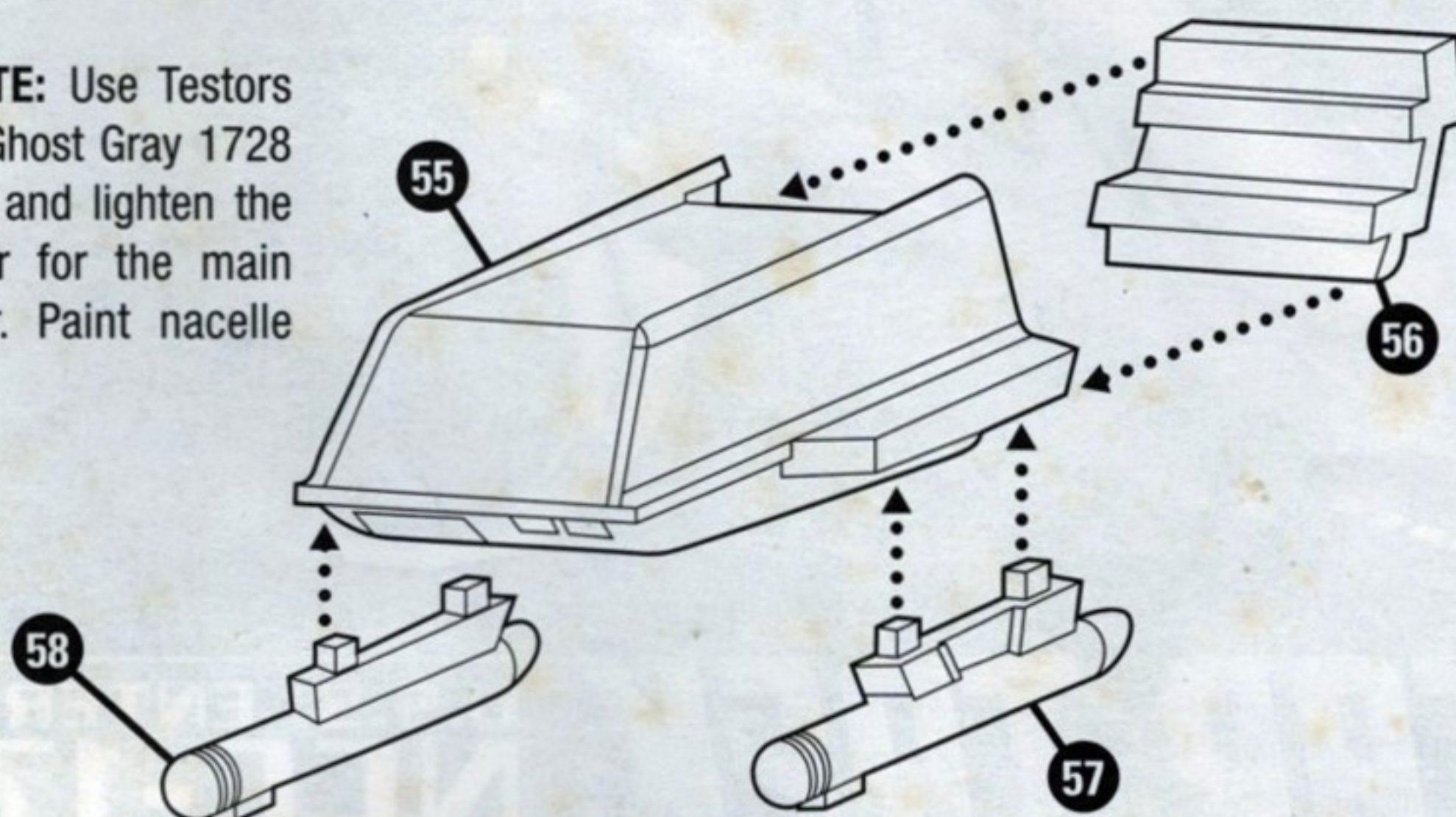

III

# 14 • FINAL ASSEMBLY

Allow all sub-assemblies to dry completely before beginning final assembly.

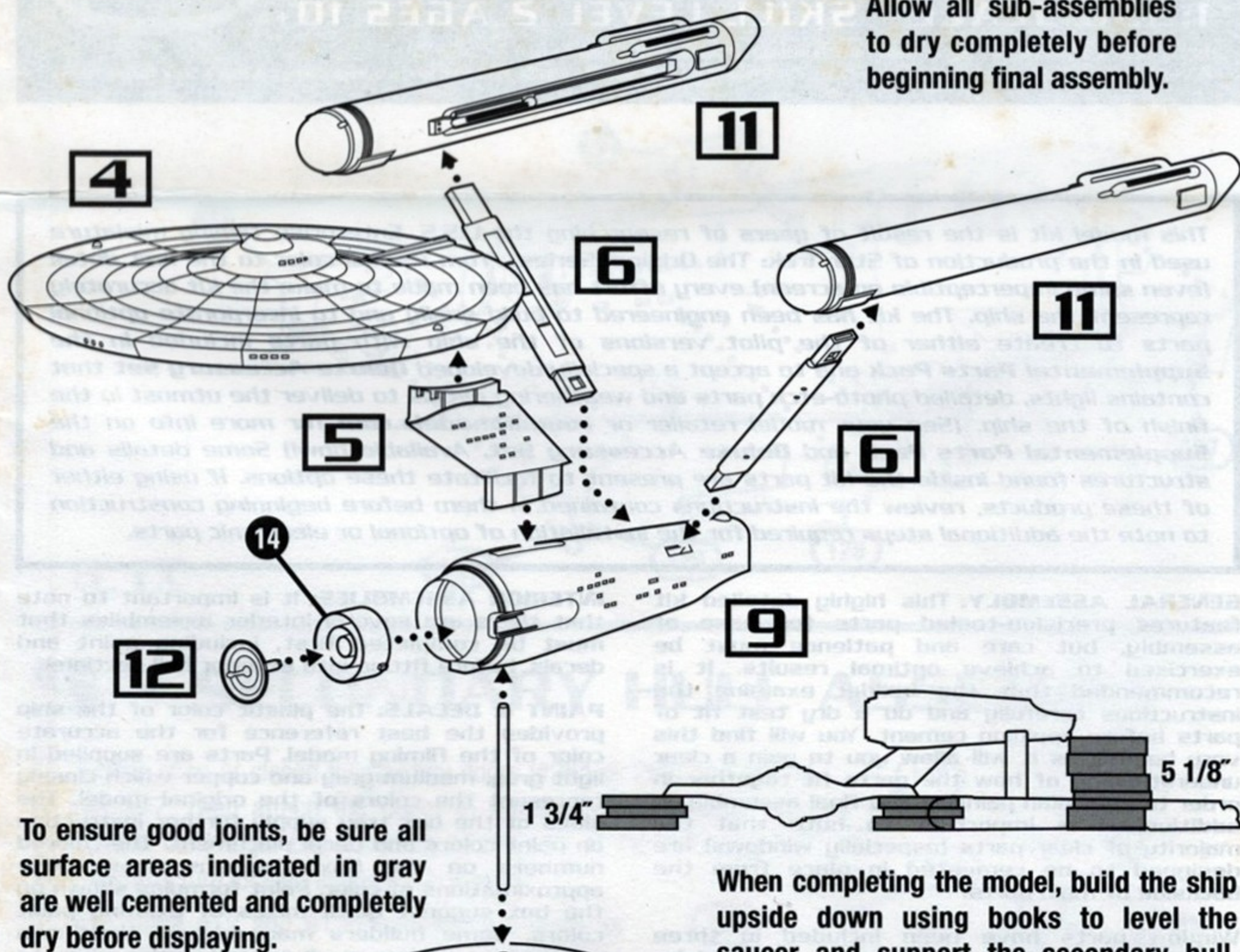

0

